

Pre-cast concrete plank
Screed laid on resilient layers

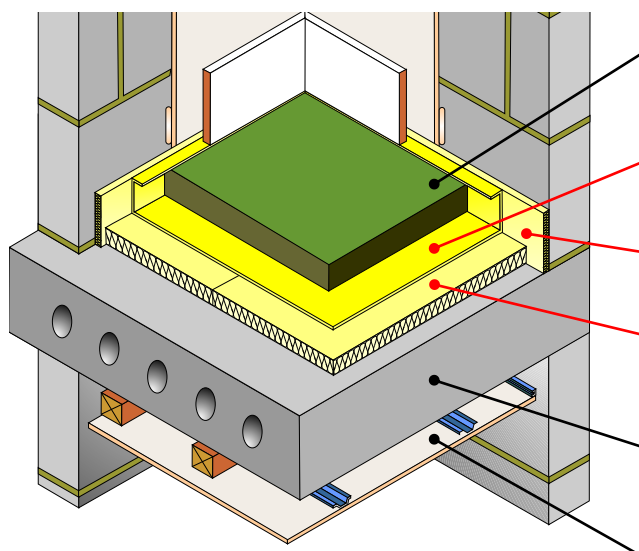

Fig. CF7

Screed	65mm (min) sand cement screed, or 40mm proprietary screed, nominal 80kg/m ² mass per unit area
Resilient layer (1)	5mm YELOfon HD5 extruded polyethylene (30kg/m ³)
Isolating edge strip	10mm YELOfon ES10/100 extruded polyethylene
Resilient layer (2)	25mm (min) X2i / X2ie extruded polystyrene insulation board (See Table CF7 for full details)
Structural floor	<ul style="list-style-type: none"> 150mm (min) pre-cast concrete floor plank slab 300kg/m² (min) mass per unit area
Ceiling	See Table CF7 for ceiling treatment options

IMPORTANT

If adopting this treatment, all three components MUST be installed:

- 1) YELOfon HD5 (resilient layer 1)
- 2) YELOFOAM X2i (resilient layer 2)
- 3) YELOfon ES10/100 (10mm isolation perimeter edge strip)



FASTRACKCAD
ARCHITECTURAL CAD DATABASES

Table CF7

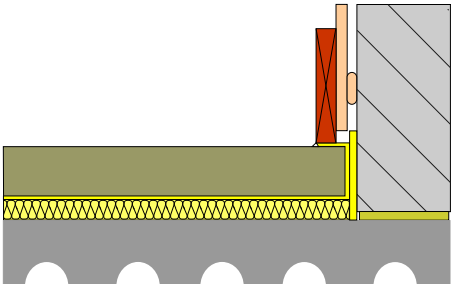
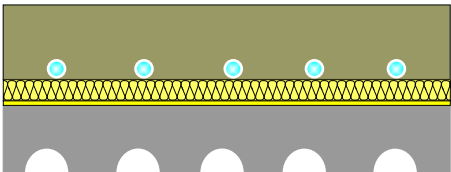
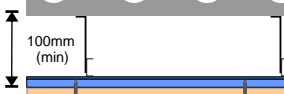
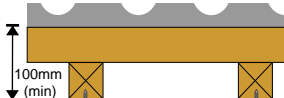
PCT resilient layers installation options	Perimeter resilient flanking strip required	Ceiling treatment options				
<p>1st Resilient layer YELOfon[®] HD5 5mm extruded polyethylene (30kg/m³) foam</p> <p>2nd Resilient layer X2i / X2ie High performance extruded polystyrene boards</p> <div><div><5</div>GWP</div> <p>All components*</p>  <p>Underfloor heating systems within screed</p>  <p>Product dimensions HD5: 5mm (t) x 1.5m (w) x 75m (l) X2i / X2ie: Refer to page 60</p> <p>* Excluding X2i</p>	<p>YELOfon[®] ES10/100</p> <p>Polyethylene foam isolation strip: 10mm (t) x 100mm (h) x 50m (l) placed around the perimeter of the flooring board to isolate floor from walls and skirting.</p>	<p>Metal frame ceiling system (CT1, 2 or 3) Any metal frame ceiling system providing 100mm (min) ceiling void</p>  <p>One layer of nominal 8kg/m² (min) gypsum-based board</p> <p>Timber batten & counter battens ONLY to be used with 150mm (min) depth concrete planks</p>  <p>One layer of nominal 8kg/m² gypsum-based board</p>				
<p>Typical PCT performance⁽²⁾</p> <div><div>$D_{nT,w} + C_{tr} = 52\text{dB}$</div><div>$L_{nT,w} = 54\text{dB}$</div></div> <p>Code credits*</p> <table><tr><td>Pol 1</td><td>Hea 2</td></tr><tr><td>1</td><td>3</td></tr></table>			Pol 1	Hea 2	1	3
Pol 1	Hea 2					
1	3					

* Code for Sustainable Homes (CSH) credits quoted are typical. Mat 1 value taken from the BRE Green Guide. Pol 1 credit is only awarded if all the other insulation products used have a GWP of <5. Hea 2 credits are based on the floor being pre-completion tested and the separating wall performing to at least the same acoustic standard. Credits subject to relevant category weighted value. See page 5 for further information.

Acoustic values

⁽²⁾ Values quoted are typical, based on the treatment being installed correctly and pre-completion tested.

Airborne performance tested in accordance with BS EN ISO 140-4:1998

Impact performance tested in accordance with BS EN ISO 140-7: 1998